SPLIT CORE CURRENT TRANSFORMERS

PowCT Hinged Series

Datasheet



5A~80A
Rated Current

333mV or mA
Output

0.5%
Accuracy

10mm/0.40"
Window Size

Description

The Powerway PowCT Series hinged split core CTs are compact and low-cost current transformers with high accuracy. Designed with a single-click installation mechanism, the hinged CTs are ideal for quick and easy installation without disconnecting cables. The compact size is perfect for limited-space panels. 333mV or mA output.

Features

- High accuracy: 0.5% from 10%-120%of rated current
- Features an inherently-safe, 333mV or mA output
- Quick installation thanks to hinged Split-Core design
- Compact design is ideal for electrical panels with limited space



Specifications

RATED CURRENT: 5A, 20A, 30A, 40A, 50A, 60A,75A,80A
Current Range: 10% - 120% of rated current
Output: 333mV,mA
Ratio:1:1000,1:2000,1:3000
Accuracy: 0.5%

MECHANICAL/ENVIRONMENTAL

Form Factor: Hinged Split-Core CT
Window Size: 10.0mm (0.40")
Exterior Dimensions: 29.4mm x 26.4mm x 41.7mm
Case Material: Black Nylon, UL 94V-0
Lead Wires: 2.0m (8ft) twisted pair, 24AWG
Operating Temperature: -15°C to 60°C / 5°F to 140°F
Operating Humidity: Non-condensing, 0 to 95% RH
Installation Conditions: Indoor Use

ELECTRICAL

Wire Polarity: White=Positive, Black=Negative
Phase Orientation: Arrow Points Towards Load
Frequency Range: 50/60Hz
Burden:20A: 33.3Ω / 30A: 33.3Ω / 40A: 25Ω /50A: 20Ω / 60A: 16.66Ω

SAFETY/COMPLIANCE

Rated Voltage: 600Vac, Category III
Certifications: CE, RoHS

Dimensions

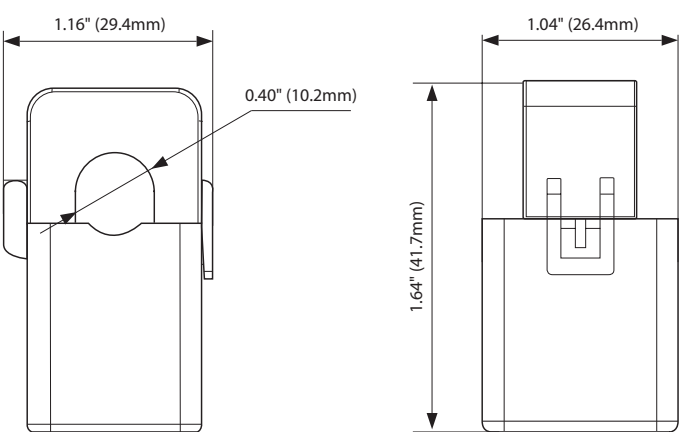

Ordering Information

Model	Rated Input	Rated Output
Ordering Number: PowCT-10	xx(A)	333mV
Ordering Example: PowCT-10-20-333	20	333
30:30A		
40:40A		
50:50A		
80:80A		

Specification include in this datasheet are subject to change without notice. Powerway reserves the right of final interpretation.(2022106V1.3)

5A~150A Rated Current	333mV or mA Output	0.5% Accuracy	16mm/0.63" Window Size
--------------------------	-----------------------	------------------	---------------------------

Description

The Powerway PowCT Series hinged split core CTs are compact and low-cost current transformers with high accuracy. Designed with a single-click installation mechanism, the hinged CTs are ideal for quick and easy installation without disconnecting cables. The compact size is perfect for limited-space panels. 333mV or mA output.

Features

- High accuracy: 0.5% from 10%-120%of rated current
- Features an inherently-safe, 333mV or mA output
- Quick installation thanks to hinged Split-Core design
- Compact design is ideal for electrical panels with limited space



Specifications

RATED CURRENT: 5A, 20A, 30A, 40A, 60A, 80A, 100A, 150A
Current Range: 10% - 120% of rated current
Output: 333mV, mA
Ratio: 1:1000, 1:2000, 1:3000
Accuracy: 0.5%

MECHANICAL/ENVIRONMENTAL

Form Factor: Hinged Split-Core CT
Window Size: 16.0mm (0.630")
Exterior Dimensions: 36.0mm x 30.5mm x 53.0mm
Case Material: Black Nylon, UL 94V-0
Lead Wires: 2.0m (8ft) twisted pair, 24AWG
Operating Temperature: -15°C to 60°C / 5°F to 140°F
Operating Humidity: Non-condensing, 0 to 95% RH
Installation Conditions: Indoor Use

ELECTRICAL

Wire Polarity: White=Positive, Black=Negative
Phase Orientation: Arrow Points Towards Load
Frequency Range: 50/60Hz
Burden: 20A: 33.3Ω / 30A: 33.3Ω / 40A: 25Ω / 50A: 20Ω / 150A: 6.66Ω

SAFETY/COMPLIANCE

Rated Voltage: 600Vac, Category III
Certifications: CE, RoHS

Dimensions

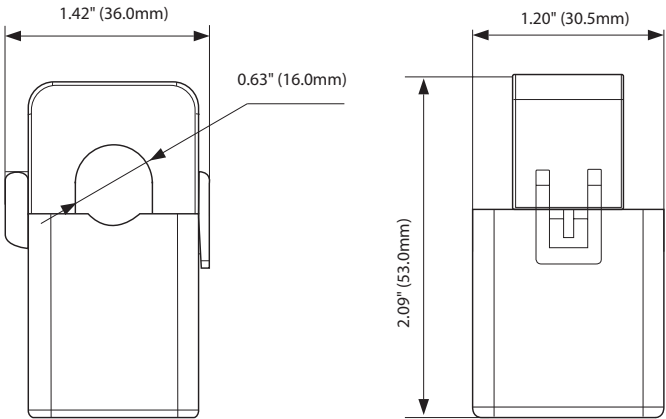

Ordering Information

Model	Rated Input	Rated Output
Ordering Number: PowCT-16	xx(A)	333mV
Ordering Example: PowCT-16-100-333	100	333
30:30A		
40:40A		
100:100A		
150:150A		

Specification include in this datasheet are subject to change without notice. Powerway reserves the right of final interpretation.(2022106V1.3)

100A~300A

Rated Current

333mV or mA

Output

0.5%

Accuracy

24mm/1.00"

Window Size

► Description

The Powerway PowCT Series hinged split core CTs are compact and low-cost current transformers with high accuracy. Designed with a single-click installation mechanism, the hinged CTs are ideal for quick and easy installation without disconnecting cables. The compact size is perfect for limited-space panels. 333mV or mA output.

► Features

- High accuracy: 0.5% from 10%-120% of rated current
- Features an inherently-safe, 333mV or mA output
- Quick installation thanks to hinged Split-Core design
- Compact design is ideal for electrical panels with limited space



Specifications

RATED CURRENT: 100A, 150A, 180A, 200A, 250A, 300A

Current Range: 10% - 120% of rated current

Output: 333mV, mA

Ratio: 1:1000, 1:2000, 1:3000, 1:5000

Accuracy: 0.5%

MECHANICAL/ENVIRONMENTAL

Form Factor: Hinged Split-Core CT

Window Size: 24.0mm (1.00")

Exterior Dimensions: 50.8mm x 38.6mm x 70.1mm

Case Material: Black Nylon, UL 94V-0

Lead Wires: 2.0m (8ft) twisted pair, 24AWG

Operating Temperature: -15°C to 60°C / 5°F to 140°F

Operating Humidity: Non-condensing, 0 to 95% RH

Installation Conditions: Indoor Use

ELECTRICAL

Wire Polarity: White=Positive, Black=Negative

Phase Orientation: Arrow Points Towards Load

Frequency Range: 50/60Hz

Burden: 20A: 33.3Ω / 30A: 33.3Ω / 120A: 8.33Ω / 200A: 5Ω / 250A: 4Ω

SAFETY/COMPLIANCE

Rated Voltage: 600Vac, Category III

Certifications: CE, RoHS

Dimensions

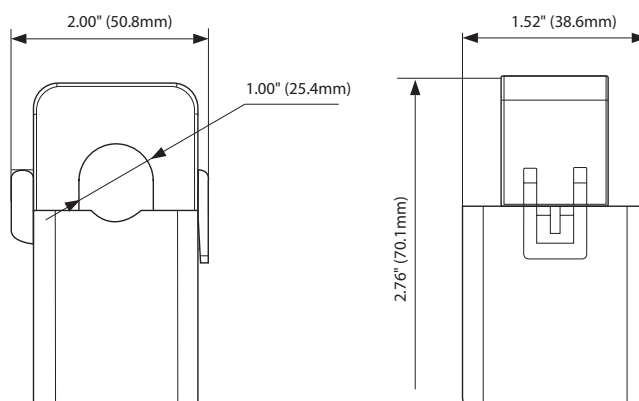

Ordering Information

Model	Rated Input	Rated Output
Ordering Number: PowCT-24	xx(A)	333mV
Ordering Example: PowCT-24-200-333	200	333
100:100A		
150:150A		
250:250A		
300:300A		

200A~630A	333mV or mA	0.5%	36mm/138"
Rated Current	Output	Accuracy	Window Size

Description

The Powerway PowCT Series hinged split core CTs are compact and low-cost current transformers with high accuracy. Designed with a single-click installation mechanism, the hinged CTs are ideal for quick and easy installation without disconnecting cables. The compact size is perfect for limited-space panels. 333mV or mA output.

Features

- High accuracy: 0.5% from 10%-120%of rated current
- Features an inherently-safe, 333mV or mA output
- Quick installation thanks to hinged Split-Core design
- Compact design is ideal for electrical panels with limited space



Specifications

RATED CURRENT: 200A, 400A, 600A
Current Range: 10% - 120% of rated current
Output: 333mV,mA
Ratio:1:1000,1:2000,1:5000,1:8000
Accuracy: 0.5%

MECHANICAL/ENVIRONMENTAL

Form Factor: Hinged Split-Core CT
Window Size: 36.0mm (1.38")
Exterior Dimensions: 65.00mm x 40.00mm x 83.00mm
Case Material: Black Nylon, UL 94V-0
Lead Wires: 2.0m (8ft) twisted pair, 24AWG
Operating Temperature: -15°C to 60°C / 5°F to 140°F
Operating Humidity: Non-condensing, 0 to 95% RH
Installation Conditions: Indoor Use

ELECTRICAL

Wire Polarity: White=Positive, Black=Negative
Phase Orientation: Arrow Points Towards Load
Frequency Range: 50/60Hz
Burden:200A: 5Ω / 400A: 5Ω / 600A: 3.33Ω

SAFETY/COMPLIANCE

Rated Voltage: 600Vac, Category III
Certifications: CE, RoHS

Dimensions

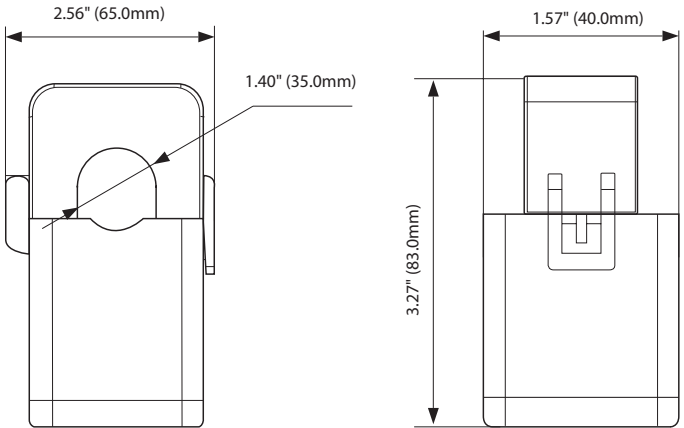

Ordering Information

Model	Rated Input	Rated Output
Ordering Number: PowCT-36	xx(A)	333mV
Ordering Example: PowCT-36-200-333	200	333
300:300A		
400:400A		
500:500A		
630:630A		